

SERVICE CONDUITS FOR LOTS STUBBED OUT TO BE CAPPED OFF.

NOTES:

- (1) CUSTOMER IS RESPONSIBLE FOR FORMING AND POURING PAD TO CO-OP'S SPECIFICATIONS.
- (2) ALL PADS MUST BE 4" ABOVE CURB GRADE.
- (3) PADS FOR TRANSFORMERS LOCATION SHALL BE DETERMINED BY A.E.C. ENGINEER.
- (4) ALL CONDUIT AND TRENCHES MUST BE INSPECTED AND APPROVED BY A.E.C. BEFORE ANY BACK FILLING.

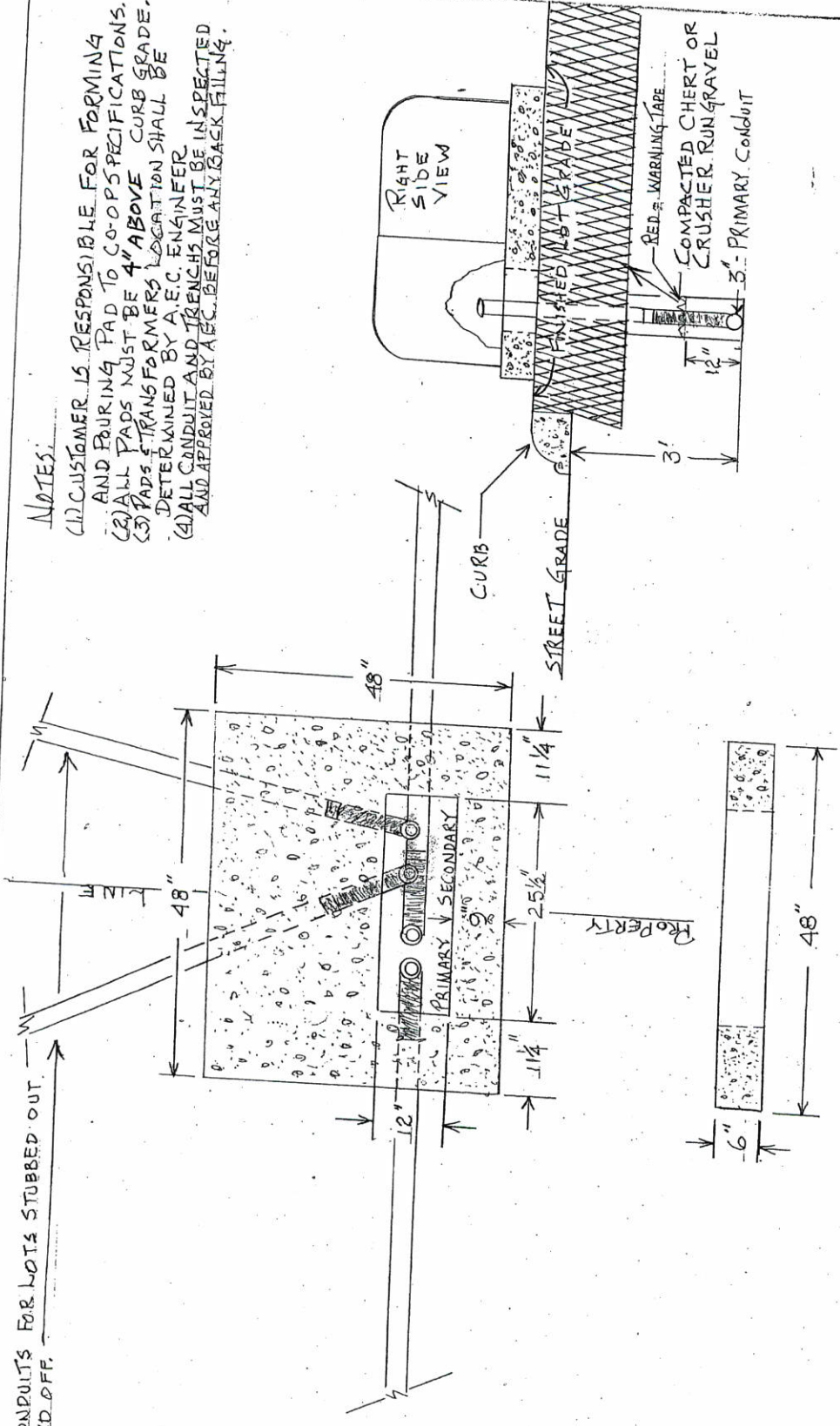

FRONT VIEW

ARAB ELECTRIC CO-OP	
SCALE: NONE	DRAWN BY: J.R.
DATE: 12-09	
TYPICAL 1 Ø TRANS. PAD.	
IN A SUBDIVISION	
DRAWING NO. _____	